

How do you program your scanner?

1.Scan Start Configuration

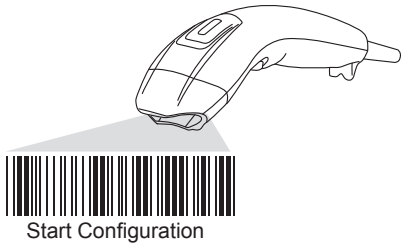

2.Scan all necessary able for parameters that Meet your application

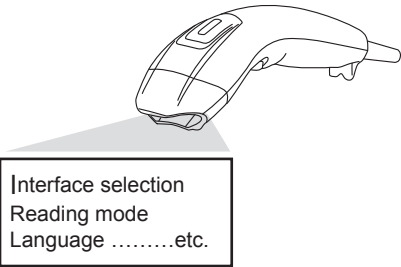

3.Scan end configuration to save the changes.

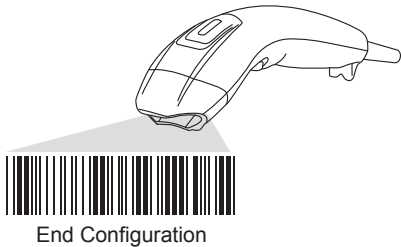

Resetting The Standard Product Defaults

If you aren't sure what programming options are in your scanner, or you've changed some options and want the factory settings restored, scan the bar code below.



Symbologies setting

- Enable



* UPC-A on



* UPC-E on



* EAN13 on



* EAN8 on



* Code39 on



* Codabar on



* Code93 on



* Code128 on



Interleaved 2of 5 on



Industrial 2 of 5 on



Matrix 2 of 5 on



MSI/Plessey on



Code32 on (Italian Pharma Code)



Code11 on



Telepen on



GS1 DataBar Omnidirectional on



GS1 DataBar Limited on



GS1 DataBar Expanded on

- Disable



UPC-A off



UPC-E off



EAN13 off



EAN8 off



Code39 off



Codabar off



Code93 off



Code128 off



* Interleaved 2of 5 off



* Industrial 2 of 5 off



* Matrix 2 of 5 off



* MSI/Plessey off



*Code32 off (Italian Pharma Code)



*Code11 off



*Telepen off



*GS1 DataBar Omnidirectional off



*GS1 DataBar Limited off



*GS1 DataBar Expanded off

WIRELESS BARCODE SCANNER
Quick Start Guide

Before Getting Started

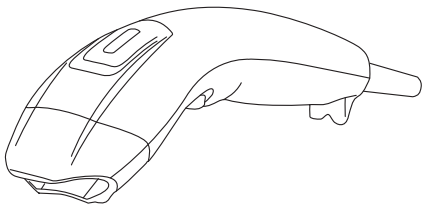

Wireless Scanner

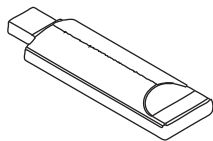

USB Receiver

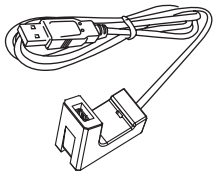

USB docking station

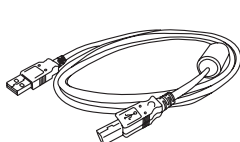

USB recharge cable

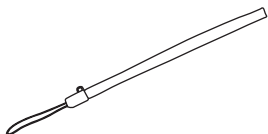

Strap

About your wireless scanner

It is one on one wireless data communication protocol. The scanner is already paired with the USB receiver. Just easily plug USB receiver and start the operation. The scanner on a real time basis, if the scanner is connected, the barcode is decoded and transmitted to the remote host without any delay. If the scanner is not connected or out of range, the data is lost (status: 2 beeps/4 beeps).

Note:
New batteries should be fully charged before their first use

Wake up your wireless scanner

Press and release the trigger on your scanner to activate it. Your scanner is ready to work when orange LED comes on .

Connect USB receiver to a host computer

The device can be quickly recognized by host computer without any software/driver installation. Within less than 10 seconds the receiver will flash red to inform the Initialization is completed.

Recharging the battery

The Red LED comes on when the battery level is low, please recharge the scanner immediately. When the scanner is charging, the LED is green (solid). A full recharge (from completely drained battery) takes approximately 4 hours. When the scanner is fully charged, the green LED will go off.

How to pair (repair) you scanner and receiver?

- Step 1: Plug the USB receiver to the scanner
- Step 2: Trigger the button on the scanner.
- Step 3: Devices are successful paired with 1 beep from scanner and 1 blink from the USB receiver.

Scanner LED indicator

Status / indicator	Beeper	Blue LED	Green LED	Red LED	Orange LED
Good Scan	1 beep	1 blink			
Transmission failure	4 beeps	4 blink			
Trasmission failure (in memory mode)	2 beeps	2 blink			
Low battery				On	
Recharge			On		
Operation mode					On
Sleeping	None	None	None	None	None

USB receiver LED indicator

Color	Indication
Red	LED will flash to present the success of transmission

Default setting of wireless scanner

- Buzzer : High
 - Vibrator: Disable
 - Memory mode: Disable
 - Power saving (sleep mode): 10min
- The default values can be modified by scanning the following options.

Note: Please scan the following barcode directly with your USB receiver on. No need to scan start and end configuration barcodes.

<Buzzer>

*High

Low

Off

<Vibration motor>

Enable

*Disable

<Memory mode>

*Disable

Enable

<Sleep mode>

*10min

30min

always on

<Dongle interface selection >

Scan the interface you wish to use and replug the USB receiver to active the new setting.

* HID-USB

USB-COM

HID USB Keyboard Country

Scan the appropriate country code below to program the keyboard for your country. As a general rule, the following characters are supported, but need special care for countries other than the United States: @ | \$ # { } [] = / ' \ < > ~

Note: Please scan the following barcode directly with your USB receiver on. No need to scan start and end configuration barcodes.

US

German

Italian

Danish

Spanish

Japanese

French

Turkey

Portuguese

Finnish

Czech

Dutch

Belgian

Norwegian

Swedish

Swiss

Terminator selection

* CR+LF

CR

Tab

LF